

ECLISSE **Delta+**

CARATTERISTICHE TECNICHE

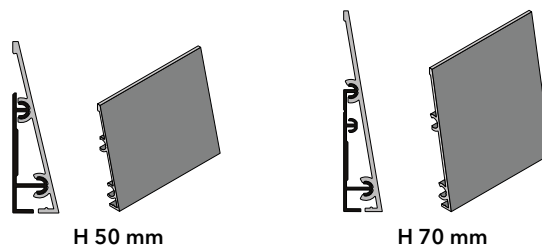

Si applica a lavoro finito con facilità e senza dover eseguire opere murarie, utilizzando semplicemente del silicone.



H 50 mm

H 70 mm

- Rastremazione da 13,5 mm a 1,6 mm
- Barre in alluminio da 2000 mm

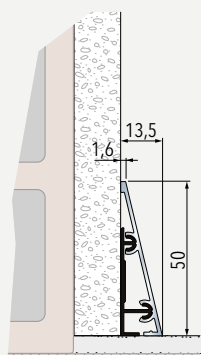

SU PARETE IN INTONACO

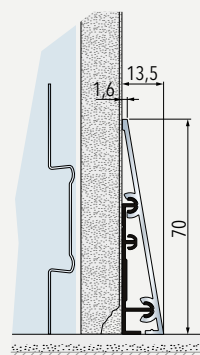

SU PARETE IN CARTONGESSO

TERMINALI E GIUNTI (da indicare in fase di ordine)

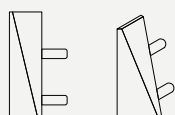
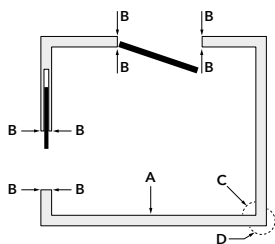

B
TERMINALI
INCLINATI

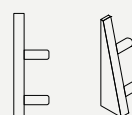

B
TERMINALI
DRITTI

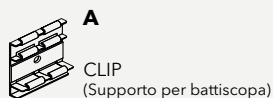

A
CLIP
(Supporto per battiscopa)



C
ELEMENTI PER
ANGOLI INTERNI

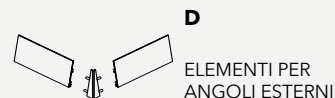

D
ELEMENTI PER
ANGOLI ESTERNI

FINITURE | Barre e terminali



BIANCO RAL 9016



NERO



CHAMPAGNE



BRONZE



TOBACCO

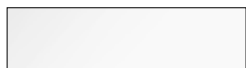

GREZZO CON PRIMER